

2017  
**FALL EXTENSION**  
CONFERENCE

Schedule and Awards Program

**October 24-25, 2017**



**POWERFUL PARTNERSHIPS**  
THROUGH DIVERSITY





# Powerful Partnerships Through Diversity

## Contents

- Welcome to FEC 2017** ..... 1
- Share Your FEC Photos** ..... 2
- MSU Extension Celebration** ..... 2
- Resource Room** ..... 3
  - ANR Technology Services ..... 3
  - Kettunen Center Opportunities ..... 3
  - MCEA Auction ..... 3
  - MSU Extension Apparel Pick-Up ..... 3
  - MSU Extension Community Behavioral Health Team ..... 3
- Conference Schedule** ..... 4
  - Preconference: Monday, October 23 ..... 5
  - Conference Day 1: Tuesday, October 24 ..... 6
  - Conference Day 2: Wednesday, October 25 ..... 10
- Finding Your Way: Free Apps** ..... 14
- The MSU Extension Awards Program** ..... 15
- Presentations on Tuesday, October 24 – Lunch** ..... 17
  - ESP Friend of Extension Award ..... 17
  - MCEA John A. Hannah Award for Program Excellence ..... 18
  - Diversity and Multiculturalism Award ..... 19
  - Innovative Technology Award ..... 20
  - Institute Team Award ..... 21



## Contents *(continued)*

<b>Presentations on Tuesday, October 24 – Dinner</b> .....	22
Key Partner Awards .....	22
Gordon Guyer Collaborative Programming Award .....	26
Outstanding Service to MSU Extension Award .....	27
<b>Presentations on Wednesday, October 25 – Lunch</b> .....	28
Meritorious Service Awards .....	28
<b>Finding Your Way: Maps of the Westin Book Cadillac Hotel</b> .....	29
Promotions and Milestone Years of Service .....	40
<b>MSU Extension Association Awards</b> .....	42
CNRDA Awards .....	42
ESP Awards .....	45
MAEA Awards .....	49
MAE4-HYS Awards .....	51
MEAFCS Awards .....	54
MSU Product Center Award .....	57
<b>Conference Sponsors</b> .....	58
<b>My Passport to Prizes</b> .....	59
<b>Finding Your Way: Map of Downtown Detroit</b> .....	61

1

## Welcome to FEC 2017

Welcome to Fall Extension Conference 2017 at the Westin Book Cadillac in Detroit! We're glad you've joined us for what is sure to be an excellent conference. Fall Extension Conference is the annual opportunity for Michigan State University Extension personnel from all across our great state to gather and hear organizational updates, learn, improve skills, and find ways to truly focus on and enhance our relationship as part of the MSU brand. The conference also allows us to recognize many outstanding faculty, staff, and key partners with various awards.

The 2017 conference theme is "Powerful Partnerships Through Diversity," with a focus on two core competencies:

- Diversity and Multiculturalism
- External Partnerships

We've also incorporated several workplace wellness concepts into the schedule, including building in opportunities for 30 minutes of physical activity a day. Just look for the  symbol on the conference schedule pages to find the physical activity options.

We're excited about the conference and hope that you are, too. We anticipate that you'll find great value in the conference's learning experiences, enjoy the chance to connect with your colleagues, and discover anew the great city of Detroit.

I'd like to thank the members of the Fall Extension Conference planning committee, who truly represent the entire organization, for their planning and organizing efforts. Please share your feedback about the conference with any member of the planning committee, either during the conference or when you return home. Committee members are: Andrea Aguilar, Eric Anderson, Terri Badgley, Anne Baker, Jennifer Berkey, Carol Blake, Betsy Braid, Luann Doriot, Cheryl Eschbach, Lynette Kaiser, Adam Koivisto, Scott Matteson, Jeannie Nichols, Katie Nicpon, Bridget Paff, Ashley Schwieterman, Ed Scott, Gwyn Shelle, Beth Stuever, Vivian Washington, Diane Wilson, and Richard Wooten.

Special thanks also to our passport prize team of Imelda Galdamez, Terry Gibb, Erin Lizotte, and Sheila Urban Smith.

I look forward to seeing you during the conference!

Sincerely,



Jennifer Berkey  
Planning Committee Chair  
Fall Extension Conference

## Share Your FEC Photos

Attention all shutterbugs! Take photos with your smartphone or borrow one of several instant cameras we have available (four in the Venetian Ballroom and one from your Workshop on the Move tour leader), then share your photos.

Please remember to submit a description with each photo that includes the following information:

- Your name
- When and where you took the photo
- Who or what is shown in the photo

### To share a digital photo:

To add a photo to the “FEC Detroit” Instagram profile, email it as an attachment to [FECdetroit@gmail.com](mailto:FECdetroit@gmail.com). You can also post it to your own Instagram account with the hashtag #FECdetroit in the caption.

### To share an instant camera photo:

The loaner instant cameras are similar to the old-style Polaroid cameras in that you take a photo and print it instantly. Then just write a description on the back and stick it up on the photo wall in the Woodward Ballroom.

### Check out the photos your colleagues took:

- Visit the FECdetroit Instagram account at [www.instagram.com/FECdetroit](http://www.instagram.com/FECdetroit) (or search for #FECdetroit on the Instagram app) to see the digital photos.
- Visit the Woodward Ballroom to see the instant camera photos.

## MSU Extension Celebration

Join us at Ford Field – where the NFL’s Detroit Lions roar – on Tuesday evening for the MSU Extension Celebration. This one-of-a-kind event will feature:

- Networking reception and on-field activities
- Special appearance by former Detroit Lions kicker Jason Hanson
- MSU Extension Awards presentation

- Praise for 100 Years of Extension in Detroit from MSU President Lou Anna K. Simon
- Al McKenzie Orchestra Performs a Motown Revue

You really won’t want to miss it!

**(Note:** Dress for the Extension Celebration is business casual – no jeans or yoga pants. MSU Extension apparel and comfortable shoes are recommended.)

## Resource Room

Please stop by the Resource Room inside the Venetian Ballroom during the conference to talk with the experts about various MSU and MSU Extension programs.

### **ANR Technology Services**

Computer acting up? Want to know which tablet is most likely to survive a farm visit or 4-H camp? Talk with the tech experts with all the answers! Service Desk staff members from ANR Technology Services will be on hand to share information and answer questions.

### **Kettunen Center Opportunities**

Visit with the director and conference planning staff from Kettunen Center, a year-round, full-service conference and retreat facility that's located on a beautiful lakefront property outside of Tustin, Michigan. Find out why Kettunen Center would be a great location for your next meeting, conference, reunion, program, or extended education event.

Kettunen Center is operated by the Michigan 4-H Foundation.

### **MCEA Auction**

As the saying goes, "Bid early and bid often!" at the Michigan Council of Extension Associations (MCEA) silent auction. Be sure to stop by to view and bid on the many thoughtful and unique items up for auction. Please drop off auction items between 7:30 and 8:50 a.m. on Tuesday, October 24.

Bidding on items will open after they've been dropped off. The auction will close at 3:55 p.m. on Tuesday, October 24.

Find out whose persistence prevailed when bid sheets are posted shortly after bidding closes. Winning bidders can pay by check (payable to MCEA), cash, or credit card. All items must be paid for and picked up between 7 and 9 a.m. on Wednesday, October 25, in the Resource Room.

Proceeds from the auction go toward the Extension Professional Development Endowed Fund, which is administered by the MCEA and supports meaningful professional improvement plans and activities submitted by MSU Extension faculty.

### **MSU Extension Apparel Pickup**

Please pick up your MSU Extension apparel order from 7:30 to 8:30 a.m. or from 3 to 3:30 p.m. on either Tuesday or Wednesday.

### **MSU Extension Community Behavioral Health Team**

MSU Extension is developing programs and events designed to engage Michigan residents in conversations to find community solutions for the ongoing mental health and substance use challenges facing their communities.

Members of the MSU Extension Community Behavioral Health Team are now certified instructors for the adult and youth Mental Health First Aid training program. The 8-hour course is designed to help participants learn to:

- Identify, understand, and respond to signs of mental illnesses and substance use disorders.

## Resource Room *(continued)*

- Decrease the stigma related to behavioral health issues such as depression, anxiety, trauma, suicide, drug use and alcohol use.
- Reach out and provide initial help and support to someone who may be developing a mental health or substance use problem or experiencing a crisis.

Find out more about Mental Health First Aid training, behavioral health issues, and resources for finding help from the Community Behavioral Health Team. (For information about Mental Health First Aid USA, which is operated by the National Council for Behavioral Health, visit [https://www.mentalhealthfirstaid.org/.](https://www.mentalhealthfirstaid.org/))

## Conference Schedule

Sessions will be held at the Westin Book Cadillac Hotel unless otherwise noted. Look for a floor indicator (for example, [F2] for second floor) after the room name in the session location column of the schedule. You'll also find floor maps near the center of the program. A list of the hotel meeting spaces that we will use during the conference follows.

- **First Floor [F1]:**
  - Building Lobby
  - Windsor Room
- **Second Floor [F2]:**
  - Boulevard Room
  - Boulevard Room A
  - Hotel Lobby
  - State Room
  - Woodward Ballroom (entire)
  - Woodward Ballroom A
- **Third Floor [F3]:**
  - Ambassador Room
  - Book Boardroom
  - Esquire Room
  - Founders Room A
  - Founders Room B
  - Jefferson Boardroom
  - Michigan Boardroom
  - Pre-Function Area
  - Washington Boardroom
- **Fourth Floor [F4]:**
  - Crystal Ballroom
  - Venetian Ballroom



## PRECONFERENCE: Monday, October 23

<b>Time</b>	<b>Session or Event</b>	<b>Location</b>
9:30 a.m.- 3:30 p.m.	Financial Home Ownership (FHE) Work Team Meeting and Lunch	Boulevard A [F2]
10 a.m.-1 p.m.	MSU Extension Administrative Team Meeting	Woodward Ballroom A [F2]
1 p.m.-4 p.m.	Are You Partnership Ready?	Founders Room A [F3]
1 p.m.-4 p.m.	MSU Extension Supervisors Meeting (by invitation only)	Woodward Ballroom A [F2]
4 p.m.-6 p.m.	Conference Registration Open	Outside of Woodward Ballroom [F2]
5 p.m.-8 p.m.	Michigan Extension Association of Family and Consumer Sciences (MEAFCS) Meeting and Dinner	Founders Room A [F3]
5:30 p.m.- 8:30 p.m.	Michigan Association of Extension 4-H Youth Staff (MAE4-HYS) Meeting and Dinner	Crystal Ballroom [F4]
5:30 p.m.- 8:30 p.m.	Michigan Association of Extension Agents (MAEA) Annual Meeting and Dinner	Detroit Beer Company (1529 Broadway St., Detroit, MI 48226)
6 p.m.-8 p.m.	Community and Natural Resources Development Association (CNRDA) Meeting and Dinner	Boulevard Room A [F2]
8 a.m.-5 p.m.	Produce Safety Training (Lunch on your own)	Venetian Ballroom [F4]

## CONFERENCE DAY 1: Tuesday, October 24

Time	Session or Event	Location
6 a.m.– 7 a.m.	 <b>Optional Physical Activity:</b> <ul style="list-style-type: none"> <li>• Stroll Through the Park</li> <li>• Tai Chi</li> </ul>	Building Lobby [F1] Esquire Room [F3]
7 a.m.– 9 a.m.	<b>Conference Registration</b>	Outside of Woodward Ballroom [F2]
7 a.m.– 9 a.m.	<b>Institute Breakfasts</b> <ul style="list-style-type: none"> <li>• Agriculture and Agribusiness Institute (AABI)</li> <li>• Children and Youth Institute (CYI)</li> <li>• Greening Michigan Institute (GMI)</li> <li>• Health and Nutrition Institute (HNI)</li> </ul>	Woodward Ballroom C&D [F2] Crystal Ballroom [F4] Founders Rooms A & B [F3] Woodward Ballroom B [F2]
7:30 a.m.– 8:30 a.m.	<b>Silent Auction Item Drop-Off and Auction Start</b>	Venetian Ballroom [F4]
7:30 a.m.– 8:50 a.m.	<b>MSU Extension Apparel Pickup</b>	Venetian Ballroom [F4]
9 a.m.– 10 a.m.	<b>Welcome – Jennifer Berkey</b> <b>Keynote Presentation – Caprice D. Hollins, Cultures Connecting LLC</b>	Woodward Ballroom [F2]
10 a.m.– 10:15 a.m.	 <b>Transition Time</b> <ul style="list-style-type: none"> <li>• Mindful Movements Wellness Activity</li> <li>• Silent Auction and Resource Room Open</li> </ul>	Pre-Function Area [F3] Venetian Ballroom [F4]
10:15 a.m.– 11:15 a.m.	<b>Breakout Session 1</b> <ul style="list-style-type: none"> <li>• Can't We Do Better? Moving From Dominant Cultural Values to Inclusive Approaches – <i>Dionardo Pizaña</i></li> <li>• Differentiating Instruction to Help Reach Limited English Language Proficiency Learners – <i>Anne Baker</i></li> <li>• Financial Accountability: Working Together for Best Practices – <i>Adam Koivisto, Sheila Smith, Jennifer Weichel</i></li> <li>• Parent Engagement With Limited-Income Families – <i>Barb Flis</i></li> </ul>	Windsor Room [F1]  Michigan Board Room [F3]  Jefferson Boardroom [F3]  Book Boardroom [F3]



## CONFERENCE DAY 1: Tuesday, October 24

Time	Session or Event	Location
	<ul style="list-style-type: none"> <li>• <b>Physical Activity Session: Is it Possible to Get Exercise at Your Desk?</b> – <i>Erin Carter</i></li> <li>• <b>Racial Microaggressions</b> – <i>Caprice D. Hollins</i></li> <li>• <b>Sea Grant World Café: Part 1 NOAA Regional Science Partners</b> – <i>Cindy Hudson, Rochelle Sturtevant, Heather Triezenberg</i></li> <li>• <b>Social Stratification</b> – <i>Courtney Cuthbertson</i></li> <li>• <b>Strategies for Effectively Working in Michigan’s Cities and Metropolitan Regions</b> – <i>Dave Ivan, Marie Ruemenapp</i></li> <li>• <b>Youth Diversion and the Role MSU Extension Can Play</b> – <i>Anthony Frontiera</i></li> </ul>	<p>Boulevard Room A [F2]</p> <p>Crystal Ballroom [F4]</p> <p>State Room [F2]</p> <p>Founders Room B [F3]</p> <p>Founders Room A [F3]</p> <p>Ambassador Room [F3]</p>
11:15 a.m.– 11:30 a.m.	<p><b>Transition Time</b></p> <ul style="list-style-type: none"> <li>• Mindful Eating Wellness Activity</li> <li>• Silent Auction and Resource Room Open</li> </ul>	<p>Pre-Function Area [F3]</p> <p>Venetian Ballroom [F4]</p>
11:30 a.m.– Noon	<p><b>Your Role in Philanthropy</b> – <i>Jeff Dwyer and Bridget Paff</i></p>	<p>Woodward Ballroom [F2]</p>
Noon– 1:30 p.m.	<p><b>Lunch and Awards Presentations</b></p> <ul style="list-style-type: none"> <li>• ESP Friend of Extension Award</li> <li>• MCEA John A. Hannah Award for Program Excellence</li> <li>• Diversity and Multiculturalism Award</li> <li>• Innovative Technology Award</li> <li>• Institute Team Award</li> </ul>	<p>Woodward Ballroom [F2]</p>
1:30 p.m.– 1:45 p.m.	<p><b>Transition Time</b></p> <ul style="list-style-type: none"> <li>• Mindful Humor Wellness Activity</li> <li>• Silent Auction and Resource Room Open</li> <li>• Board Buses for Workshops on the Move</li> </ul>	<p>Pre-Function Area [F3]</p> <p>Venetian Ballroom [F4]</p> <p>Building Lobby [F1]</p>

## CONFERENCE DAY 1: Tuesday, October 24

Time	Session or Event	Location
1:45 p.m. – 4:45 p.m.  (Buses leave promptly at 1:45 p.m.)	<p><b>Workshops on the Move 1</b> (Concurrent With Breakout Sessions 2 and 3)</p> <ul style="list-style-type: none"> <li>• Belle Isle Tour</li> <li>• Detroit Historical Museum Tour</li> <li>• Detroit People Mover Tour</li> <li>• Eastern Market and Pingree Farms Tour</li> <li>• Experience Diverse Cultures and Ethnicities of Michigan Tour (<b>Note:</b> Women must bring a headcovering.)</li> <li>• Ford Field Physical Activity</li> </ul>	Building Lobby [F1]
1:45 p.m. – 2:45 p.m.	<p><b>Breakout Session 2</b></p> <ul style="list-style-type: none"> <li>• 4-H Grows Science: Linking Schools with 4-H Science Resources and Experts – <i>Alan Jaros, Norm Lownds</i></li> <li>• Citizen Science: Promoting Community Collaboration and Engagement for Enduring Impact – <i>Bindu Bhakta, Julie Crick, Yu Man Lee</i></li> <li>• Civil Discourse and Race Relations – <i>Rich Pirog, Dionardo Pizafía</i></li> <li>• Exploring Whiteness Part 1 – <i>Mark Cowan, Courtney Cuthbertson</i></li> <li>• Facilitation Skills, Will You Thrive or Survive Your Next Meeting? – <i>Jodi Schulz, Jennifer Weichel</i></li> <li>• Improving Parity and Impact Through Online Programming with Low-Income and Diverse Audiences – <i>Heidi Lindberg, Erin Lizotte, Gwen Shelle</i></li> <li>• MSU Extension DPTV Collaboration and Partnership – <i>Georgeann Herbert, Carrie Shrier</i></li> <li>• Sea Grant World Café: Part 2 NOAA Regional Science Partners – <i>Cindy Hudson, Rochelle Sturtevant, Heather Triezenberg</i></li> <li>• Strategies for Publishing Your Community Work – <i>Diane Doberneck</i></li> <li>• Working with Deaf and Hearing Impaired Audiences – <i>Sandria Graham, Eileen Haraminac</i></li> </ul>	<p>Founders Room A [F3]</p> <p>Boulevard Room A [F2]</p> <p>Michigan Boardroom [F3]</p> <p>Ambassador Room [F3]</p> <p>Esquire Room [F3]</p> <p>Founders Room B [F3]</p> <p>Book Boardroom [F3]</p> <p>State Room [F2]</p> <p>Windsor Room [F1]</p> <p>Jefferson Boardroom [F3]</p>

## CONFERENCE DAY 1: Tuesday, October 24

Time	Session or Event	Location
2:45 p.m.– 3 p.m.	<b>Transition Time</b> <ul style="list-style-type: none"> <li>• Mindful Walking Wellness Activity</li> <li>• Silent Auction and Resource Room Open</li> </ul>	Pre-Function Area [F3] Venetian Ballroom [F4]
3 p.m.– 3:30 p.m. 	<ul style="list-style-type: none"> <li>• <b>Hotel Check-In</b></li> <li>• <b>MSU Extension Apparel Pickup</b></li> <li>• <b>Stroll Through the Park</b></li> </ul>	Hotel Lobby [F2] Venetian Ballroom [F4] Building Lobby [F1]
3:30 p.m.– 3:45 p.m.	<b>Transition Time</b> <ul style="list-style-type: none"> <li>• Mindful Body Scan Wellness Activity</li> <li>• Silent Auction and Resource Room Open (Note: Auction closes at 3:55 p.m.)</li> </ul>	Pre-Function Area [F3] Venetian Ballroom [F4]
3:45 p.m.– 4:45 p.m.	<b>Breakout Session 3</b> <ul style="list-style-type: none"> <li>• Commercial Aquaculture Business Siting: A Partnership for Integrating Data for Informed Decision Making – <i>Kyle Herreman, Dana Infante, Bill Knudson, Betsy Riley, Heather Triezenberg</i></li> <li>• Exploring Whiteness Part 2 – <i>Mark Cowan, Courtney Cuthbertson</i></li> <li>• Locating Resources for Diversity and Multiculturalism – <i>Anne Baker</i></li> <li>• Physical Activity Session: Stress Less with Mindfulness – <i>Tracie Abram, Suzanne Pish</i></li> <li>• Ripple Mapping – <i>Brad Neumann, Bethany Prykucki</i></li> <li>• Rx for Health Referral Program – <i>Cathy Newkirk, Holly Tired</i></li> <li>• Social Media: # Trend or Not – <i>Christine Heverly, Sheila Urban Smith</i></li> <li>• Starting and Sustaining a School Garden in a Nutshell – <i>Kristine Hahn, Alan Jaros</i></li> <li>• Urban Collaborators: Promoting Healthy and Sustainable Communities Through Applied, Practical, and Neighborhood-Based Solutions – <i>Zenia Kotval, Marie Ruemenapp</i></li> <li>• Workplace Wellness and Work-life Balance – <i>Lydia Weiss</i></li> <li>• Youth Resilience in Parental Death and Divorce – <i>Karin Stevens</i></li> </ul>	Michigan Boardroom [F3]  Ambassador Ballroom [F3]  Boulevard Room A [F2]  Windsor Room [F1]  Book Boardroom [F3]  Jefferson Ballroom [F3]  Esquire Room [F3]  Founders Room B [F3]  Washington Boardroom [F3]  Founders Room A [F3]  State Room [F2]

## CONFERENCE DAY 1: Tuesday, October 24

Time	Session or Event	Location
4:45 p.m.- 5:30 p.m.	<b>Free Time and Travel to Ford Field</b> <ul style="list-style-type: none"> <li>• 15- to 20-minute guided walk to Ford Field (meet at 5 p.m.)</li> <li>• Bus travel to Ford Field (meet at 5 p.m.)</li> </ul>	Building Lobby [F1]
5:30 p.m.- 6:45 p.m.	 <b>MSU Extension Celebration Networking Reception and On-Field Activities</b>	Ford Field Atrium and Football Field
6:45 p.m.- 9 p.m.	<b>MSU Extension Celebration Dinner and Award Presentations</b> <ul style="list-style-type: none"> <li>• Key Partner Awards</li> <li>• Gordon Guyer Collaborative Programming Award</li> <li>• Outstanding Service to MSU Extension Award</li> </ul>	Ford Field Atrium

## CONFERENCE DAY 2: Wednesday, October 25

Time	Session or Event	Location
6 a.m.- 7 a.m.	 <b>Optional Physical Activity:</b> <ul style="list-style-type: none"> <li>• Stroll Through the Park</li> <li>• Tai Chi</li> </ul>	Building Lobby [F1] Esquire Room [F3]
6:45 a.m.- 8:30 a.m.	<b>Epsilon Sigma Phi (ESP) Breakfast</b>	Founders Rooms A & B [F3]
7 a.m.- 8:30 a.m.	<b>General Breakfast</b>	Woodward Ballroom [F2]
7 a.m.- 9 a.m.	<b>Auction Item Pick-Up</b>	Venetian Ballroom [F4]
7:30 a.m.- 8:30 a.m.	<b>MSU Extension Apparel Pickup</b>	Venetian Ballroom [F4]
8:30 a.m.- 9 a.m.	<b>Transition Time</b> <ul style="list-style-type: none"> <li>• Resource Room Open</li> <li>• Waking Up With Humor Wellness Activity</li> </ul>	Venetian Room [F4] Pre-Function Area [F3]
9 a.m.- 9:30 a.m.	<b>The Most Exciting Administrative Updates EVER! - Patrick Cudney</b>	Woodward Ballroom [F2]

## CONFERENCE DAY 2: Wednesday, October 25

Time	Session or Event	Location
9:30 a.m.– 9:45 a.m.	<ul style="list-style-type: none"> <li>• <b>Transition Time</b></li> <li>• <b>Board Buses for Workshops on the Move 2</b></li> </ul>	Building Lobby [F1]
9:45 a.m.– Noon  (Buses leave promptly at 9:45 a.m.)	<ul style="list-style-type: none"> <li>• <b>Workshops on the Move 2</b> (Concurrent With Breakout Sessions 4 and 5)</li> <li>• Detroit District Tour</li> <li>• Detroit Institute of the Arts Tour</li> <li>• Detroit People Mover Tour</li> <li>• Outdoor Adventure Center Tour</li> <li>• D-Town Farm Tour</li> </ul>	Building Lobby [F1]
9:45 a.m.– 10:45 a.m.	<p><b>Breakout Session 4</b></p> <ul style="list-style-type: none"> <li>• 4-H Creative and Expressive Arts: Voices of Youth – <i>Kathy Fischer, Sheila Smith</i></li> <li>• Best Practices for MSU Extension Programming in Farmers Markets That Appeal to Diverse Audiences – <i>Amanda Shreve, Kendra Willis</i></li> <li>• Building Collaborations to Strengthen Programs and Impact – <i>Bruce Haas</i></li> <li>• Designing a Multilingual Online Course – <i>Gwyn Shelle</i></li> <li>• Don't Cross the Line! Setting and Communicating Boundaries – <i>Christine Heverly, Jennifer Weichel</i></li> <li>• Engaging External Partners to Foster the Growth of the Great Lakes Hop and Barley Conference – <i>Erin Lizotte, Ashley McFarland, Rob Serrine</i></li> <li>• Food Evolution Part 1 – <i>Ted Ferris, Rebecca Grumet</i></li> <li>• Listen Deeply, Think Creatively, Partner Across Institutes and Build a Bundled Series that Really Makes a Difference – <i>Eileen Haraminac, Micah Loucks, Sulaiman Mansour, Diane Rellinger</i></li> </ul>	<p>Jefferson Boardroom [F3]</p> <p>State Room [F2]</p> <p>Windsor Room [F1]</p> <p>Michigan Boardroom [F3]</p> <p>Boulevard Room B [F2]</p> <p>Washington Boardroom [F3]</p> <p>Founders Room A [F3]</p> <p>Esquire Room [F3]</p>



## CONFERENCE DAY 2: Wednesday, October 25

Time	Session or Event	Location
	<ul style="list-style-type: none"> <li>Physical Activity Session: How to Successfully Host a Healthy Meeting: Food, Beverages, Physical Activity and Sustainability – <i>Bree Carlson, Dawn Earnesty</i></li> <li>Preparing Your Step II Portfolio – <i>Marie Ruemenapp, Matt Shane</i></li> <li>Senior Nutrition and Aging Simulation – <i>Kristi Evans, Erin Powell</i></li> <li>Tips for Personal and Professional Networking – <i>Lisa Bottomley, Jodi Schulz</i></li> </ul>	<p>Founders Room B [F3]</p> <p>Ambassador Room [F3]</p> <p>Book Boardroom [F3]</p> <p>Boulevard Room A [F2]</p>
10:45 a.m. – 11 a.m. 	<b>Transition Time</b> <ul style="list-style-type: none"> <li><b>Fitness Jenga Wellness Activity</b></li> <li>Resource Room Open</li> </ul>	<p>Pre-Function Area [F3]</p> <p>Venetian Ballroom [F4]</p>
11 a.m. – Noon	<b>Breakout Session 5</b> <ul style="list-style-type: none"> <li>4-H Programming for Differently Abled Youth – <i>Kathy George, Janelle Stewart, Karin Stevens</i></li> <li>Assistive Technology to Prevent Secondary Injury in Aging Farmers – <i>Deb Chester, Ned Stoller</i></li> <li>Core Competencies for Extension Workers – <i>Murari Suvedi</i></li> <li>Delegation Skills – the Ins, Outs, Ups and Downs – <i>Lisa Bottomley, Jodi Schulz</i></li> <li>Food Evolution Part 2 – <i>Ted Ferris, Rebecca Grumet</i></li> <li>Go Where the Relationships Are – <i>Zelda Felix-Mottley, Eric Walcott</i></li> <li>Hiring a Diverse Staff and Using Diverse Skills to Reach Broader Audiences – <i>Kristi Evans, Saneya Moore</i></li> <li>Improving Success of New MSU Extension Staff – <i>James DeDecker, Ron Goldy, Mark Longstroth, Ben Phillips, Emily Pochubay</i></li> </ul>	<p>Esquire Room [F3]</p> <p>Michigan Boardroom [F3]</p> <p>Windsor Room [F1]</p> <p>Founders Room B [F3]</p> <p>Founders Room A [F3]</p> <p>Ambassador Room [F3]</p> <p>State Room [F2]</p> <p>Boulevard Room B [F2]</p>



## CONFERENCE DAY 2: Wednesday, October 25

Time	Session or Event	Location
	<ul style="list-style-type: none"> <li>• Infusing Programming, Partners and Teamwork: How Summer Employment Programs for Youth Achieved Multiple Outcomes – <i>Laurie Rivetto, Jackelyn Martin</i></li> <li>• Native American Research Project – <i>John Norder, Christie Poitra, Erica Tobe</i></li> <li>• <b>Physical Activity Session: Creating a Field Day at Your School</b> – <i>Karen Barbash, Calli Brannan, Ashley Nelson</i></li> <li>• Tools to Develop a Successful Grant Program – <i>Jennifer Berkey, Brian Klatt, Tom Lyons, Heather Triezenberg</i></li> </ul>	<p>Washington Boardroom [F3]</p> <p>Jefferson Boardroom [F3]</p> <p>Boulevard Room A [F2]</p> <p>Book Boardroom [F3]</p>
Noon– 1:30 p.m.	<p><b>Lunch and Awards Presentation</b></p> <ul style="list-style-type: none"> <li>• Meritorious Service Awards</li> <li>• Promotions</li> <li>• Milestone Years of Service</li> </ul>	Woodward Ballroom [F2]
1:30 p.m.– 3 p.m.	<p><b>Building the Most Important Community: Our Own</b> – <i>Jeff Dwyer</i></p>	Woodward Ballroom [F2]
3 p.m.– 3:30 p.m.	<p><b>MSU Extension Apparel Pickup</b></p>	Venetian Ballroom [F4]

## Finding Your Way: Free Apps

A few free apps to help you navigate in Downtown Detroit are listed in the following table. Unless otherwise noted, all apps are available for iOS and Android devices.

App Name & Developer	App Description (from App Store or Google Play Store)
Detroit Map	This app will help you determine your location, guide you to your destination, plan your subway route and find nearby businesses, restaurants, and attractions.
Detroit Travel Guide with Offline City Street Map	Interactive maps with points of interest including nightlife activities, shopping, safety tips, museums, theaters, and more.
*Detroit Travel Guide (ETIPS INC)	City guide with local tips and detailed offline maps.
Stop 313 Detroit (NgeosOne LLC)	Your guide to Detroit's public transportation system. Find out when your next bus is going to come.
QLINE Detroit (Passport Parking)	Detroit's mobile ticketing app to ride the streetcar. Pay transit fare from your smartphone.
Detroit Free Press or Detroit News (Gannett)	Local, state, and national news, weather, sports scores, and more.
ParkDetroit (Passport Parking Inc.)	Use this app to pay for parking in the city of Detroit. Look for the ParkDetroit logo on street signs and meters. Pay from your car using your phone, extend time remotely, have receipts emailed to you. App is free, but there is a \$0.15 per transaction fee, and parking must be paid for in 1-hour increments.

\* Android only.



THE  
**MSU EXTENSION**  
AWARDS PROGRAM



MICHIGAN STATE UNIVERSITY | Extension





## The MSU Extension Awards Program

Michigan State University Extension presents a variety of awards at its Fall Extension Conference each year. The awards honor outstanding MSU Extension staff members, programs, and key partners. The selection committee for the MSU Extension administration awards is made up of Extension administrators who represent institutes, district coordinators, and the MSU Extension Director's Office. Epsilon Sigma Phi chooses the Friend of Extension Award winners and the Michigan Council of Extension Associations chooses the John A. Hannah Award for Program Excellence winners.

MSU Extension staff members who have received awards from their professional associations at preconference meetings and throughout the year are also listed in this book. The professional associations are:

- Community and Natural Resources Development Association (CNRDA)
- Epsilon Sigma Phi (ESP), Alpha Psi Chapter
- Michigan Association of Extension Agents (MAEA)
- Michigan Association of Extension 4-H Youth Staff (MAE4-HYS)
- Michigan Council of Extension Associations (MCEA)
- Michigan Extension Association of Family and Consumer Sciences (MEAFCS)

## **ESP Friend of Extension Award**

### **GreenStone Farm Credit Services**

**David Armstrong**

One of America's largest rural lenders, GreenStone Farm Credit Services is an essential part of Michigan's rural economy, providing support for established and emerging farms and for agriculture-related businesses.

The organization has been a long-standing supporter of MSU Extension. Most recently, GreenStone has joined MSU Extension's efforts to help farmers and farm families weather a serious downturn in the agricultural economy.

Falling crop and milk prices have placed great financial and emotional stress on Michigan agriculture producers, farms, and farm families. GreenStone backed the MSU Extension Farm Stress Team as they developed a workshop to train people who work with agricultural producers and farm families to spot the signs and symptoms of stress, depression, self-harm, and mental health issues, and to communicate effectively with farm families in distress. GreenStone staff members have attended the MSU Extension training, helped spread the word about the program, and sponsored local sessions.

GreenStone's sponsorship and assistance have strengthened MSU Extension's capacity for offering one-on-one farm financial planning and programs on topics such as the federal Farm Bill, benchmarking, and farm finances. Together, we provide Michigan producers, farms, and farm families with critical information that helps them to make more informed management decisions. Congratulations to GreenStone Farm Credit Services, our 2017 Friend of Extension.



## MCEA John A. Hannah Award for Program Excellence

### Protecting Pollinators by Educating Extension Professionals & Greenhouse Growers

**Heidi Lindberg, David Smitley**

Protecting Pollinators by Educating Extension Professionals and Greenhouse Growers is an innovative multipronged approach to promoting pollinator health.

In 2015 the Protecting Pollinators Team worked with North Carolina State University to organize the first national Protecting Pollinators in Ornamental Landscapes Conference, which was held in Hendersonville, North Carolina. The event drew 187 Extension professionals and industry representatives from 35 states and three countries. Just over half of the conference participants indicated that the training had helped them develop local pollinator programs that reached nearly 20,000 people.

The second such conference was held earlier this month in Traverse City, Michigan.

Greenhouse and nursery growers need research-based information and training to cope with increased regulation and reduced access to pest control products. After attending the Protecting Pollinators local stakeholder meetings and a webinar on growing bee-friendly plants, 23 ornamental plant growers – who manage more than 10 million square feet of production space in nine West Michigan counties – implemented bee-friendly best management practices on plant material worth more than \$3.5 million.

The team's programming on biological pest controls included a three-day tour of operations in Ontario, many presentations, a publication and an online course (which both won NACAA awards), and 15 MSU Extension News articles with nearly 12,500 views. Sixty percent of action-impact survey respondents reported implementing new biological control programs that helped protect crops worth \$4.46 million.

This team's programming is essential to the Michigan floriculture industry and to the success and sustainability of agriculture in the United States, which is why we're honoring them with the John A. Hannah Award for Program Excellence.

## Diversity & Multiculturalism Award

### Kaitlin Wojciak

MSU Extension Community Food Systems educator Kaitlin Wojciak has led an innovative conversation about diversity and racial equity during her three years with the organization. She has connected with university units including the Center for Regional Food Systems (CRFS) and the Office of Inclusion, Equity, and Diversity in the College of Agriculture and Natural Resources to start and continue conversations on inclusion.

In 2016, Kaitlin led an effort to bring a racial equity workshop from the People's Institute for Survival and Beyond to MSU Extension and CRFS staff and to community food systems leaders of color in Michigan. After the workshop, MSU Extension Diversity and Personnel Specialist Dionardo Pizaña created a continuing learning community for participants that included four more days of workshops and sessions that Kaitlin cofacilitated.

Thanks to Kaitlin's passion for promoting racial equity in MSU Extension, an informal network of MSU Extension staff has sprung up to hold us accountable for keeping our organizational commitment to diversity and inclusion. MSU Extension thanks Kaitlin for her commitment to this important work.



## Innovative Technology Award

### Adaptive Learning for Adult Learners Team

Ellen Darnall, Alan Pilkenton, Erin Powell, Gwyn Shelle

In 2016 the dynamic Adaptive Learning for Adult Learners Team received an Innovation Grant from the national eXtension Foundation to study the use of adaptive learning tools in Cooperative Extension programming. The team researched and evaluated existing tools, consulted with online learning experts who use adaptive learning in their programs, and developed and piloted new materials.

In traditional online learning courses, all learners follow roughly the same path as they work through the same information. In adaptive learning, the learners' current knowledge level is assessed at the start of a class or module, then custom programs are created for the individual learners to help them fill in gaps in what they know.

The team chose the Environmental Management unit of the online Horse Facility Design and Management course to pilot what they learned. Pilot participants reported that they felt more confident about what they learned and appreciated being able to target material they needed to review more thoroughly in order to master the course information.

We look forward to incorporating the team's innovative work on adaptive learning into more MSU Extension programs.



## **Institute Team Award**

### **Northeast Michigan Prescription for Health Team**

**Cindy Anderson, Amy Attwell, Denise Aungst, Courtney Cuthbertson, Angela Jernstadt, Nicole Persing-Wethington, Nick Pung, Kathy Raphael, Sarah Rautio, Tara Roberson, Patti Spinella, Jessica St. George, Beth Wood, Peggy Zettle**

Between May 2016 and May 2017, the Northeast Michigan Prescription for Health Team, which covers 14 counties in MSU Extension districts 4 and 14, offered 40 six-week sessions of the Eat Healthy, Be Active series. The sessions were offered at sites throughout the area and taught by SNAP-Ed and other MSU Extension nutrition education staff.

Participants received alternative prescriptions from their health care providers to attend the series, where they learned how to make healthy food choices, save money on produce, cook nutritious meals, preserve food, and incorporate physical activity into their everyday lives. The Prescription for Health program is funded by a grant from the Michigan Health Endowment Fund.

These were the first Eat Healthy, Be Active sessions offered at several of the sites. The improved ease of access and referrals from health care providers combined to increase participation in the program from one class with one participant in 2015 to several classes with 79 adults in just the first four months of 2017.

More than 500 participants have attended the nutrition education series, and many have reported telling other people about their positive experiences in the program, further increasing the team's reach.



## Key Partner Awards

### Detroit Public Television

**Georgeann Herbert, Rich Homberg**

In January 2016, Detroit Public Television (DPTV) and MSU agreed to partner on a 24/7 children's channel. A year later, they launched Detroit PBS Kids. MSU Extension is DPTV's principal university partner in the relationship because delivering resources and programs directly to children and families is so important to both organizations. The first focus of the partnership has been early childhood education and family outreach.

MSU Extension Children and Youth Institute educators and DPTV have worked together on programming efforts that connect MSU Extension News articles with PBS programs and parent resources. The organizations have developed short videos that promote parent involvement in science education and have worked to integrate *Pre-School U* resources into MSU Extension-sponsored training events for parents, child care providers, and other early childhood professionals.

*Pre-School U* is a research-based PBS curriculum that features fun everyday activities that parents and adult caregivers can do with their kids to boost school readiness. The activities are accompanied by video and written materials that explain how to reinforce what kids are learning and link to related PBS programs and resources.

In June 2017, DPTV and MSU Extension partnered on a Detroit Kids Club Live event that featured nutrition, physical activity, and science activities for young children. The event drew thousands of children and families. Another successful joint venture that month allowed young people attending 4-H Exploration Days to earn up to six different digital badges through DPTV's Digital Badging/Connected Learning Program.

Early indications are that this growing partnership, which combines MSU Extension's expertise in community education and outreach with DPTV's media platform in Southeast Michigan, holds great promise for supporting Michigan families.

## **Michigan Farmers Market Association**

### **Dru Montri**

The mission of the Michigan Farmers Market Association (MIFMA) is to advance farmers markets to create a thriving marketplace for local food and farm products. The association's programs have expanded markets for small businesses and farms, educated leaders across Michigan to create marketplaces that are embedded in communities, and improved food access in rural and urban communities.

According to the MIFMA website, more than 160 of about 300 farmers markets in the state are now licensed to accept SNAP (Supplemental Nutrition Assistance Program) benefits for approved food items. In 2015 consumers redeemed more than \$1.2 million worth of SNAP benefits at Michigan farmers markets, giving Michigan the highest SNAP farmers market sales total of any Midwestern state.

MIFMA partners with MSU Extension education programs in nutrition and food access, food safety, community food systems, fruit and vegetable production, and using technology to extend the growing season for specialty crops. The association helped develop MSU Extension's Discover Michigan Fresh nutrition and local foods program and has worked with food safety educators to demonstrate safe sampling at farmers markets.

The partnership between MIFMA and MSU Extension makes it possible for our nutrition educators to improve food access by guiding families that use SNAP benefits through farmers markets, where they meet local vendors, discuss food safety and nutrition, and discover that fresh, locally sourced food can be affordable.

MIFMA Executive Director Dru Montri has led the association since it was founded in 2006. Since then, MIFMA has led or been involved with programs such as Double Up Food Bucks, Farm-Based Education (videos and field guides), the Farmers Market at the Capitol, Hoophouses for Health, and the Michigan Farmers Market Conference. MIFMA also advocated for passage of the 2010 Michigan Cottage Food Law and expansion of programs supporting farmers markets and direct market farmers in the 2014 Farm Bill.

The association has helped create a robust marketplace for farm products and small producers to succeed and incubate at farmers markets, which creates opportunities for entrepreneurs such as those served by the MSU Product Center. Without a doubt, MIFMA is a key partner to MSU Extension in improving food access and nutrition education for some of Michigan's most vulnerable populations and in increasing agricultural profitability.

## Southeast Michigan Council of Governments

**Kathy Lomako, Amy Mangus**

The Southeast Michigan Council of Governments (SEMCOG) is a planning partnership of local governments serving 4.7 million people in a seven-county region in Southeast Michigan. Its main purpose is to help local governments improve and maintain Southeast Michigan's transportation systems, environmental quality, economic interests, and infrastructure.

SEMCOG has worked with MSU Extension and Michigan Sea Grant for many years, providing office space for Sea Grant staff and leading efforts to create collaborative partnerships and secure grant funding for MSU Extension.

The organization has worked with MSU Extension on educational programs on topics such as the blue-green economy, land use and strategic development planning, nonmotorized transportation, placemaking, housing, air and water quality, and green infrastructure. In 2015 and 2016, SEMCOG and Sea Grant conducted a series of workshops to educate local leaders and decision makers on the benefits and how-to's of green infrastructure. The workshops increased MSU Extension's visibility with SEMCOG's member communities, and both organizations have developed reputations as go-to resources on green infrastructure and sustainable community development issues.

Much like MSU Extension, SEMCOG is woven into the fabric of the communities it serves and seeks to build relationships and partnerships with organizations with similar goals. SEMCOG is truly a key partner for MSU Extension. As one MSU Extension staff member wrote, "We believe SEMCOG is deserving of recognition" because their "policy work is based in solid research techniques, effective public engagement strategies, and a vision for the future of Southeast Michigan."

## **United Dairy Industry of Michigan**

**James Reid, Sharon Toth**

The United Dairy Industry of Michigan (UDIM) is the umbrella organization for the Dairy Council of Michigan and the American Dairy Association of Michigan. UDIM represents the nearly 1,800 dairy farms in the state and is committed to educating consumers about the health benefits of milk and the economic impact of milk production and sales on local communities. The organization's support has also been vital to dairy producers, health professionals, and schools, and to many MSU Extension education and outreach programs.

UDIM has provided significant technical, financial, and material support to MSU Extension agriculture and agribusiness events and programs, to health and nutrition staff who work with schools that are participating in the Fuel Up to Play 60 program, and to 4-H and other children and youth programs. The organization has supplied or funded the purchase of educational resources, supplies, and equipment that promote healthy living, and has funded field trips to dairy farms for young people.

The association also provides significant financial and technical support for the Fuel Up to Play 60 nutrition and physical activity program, which MSU Extension operates in schools throughout Michigan. "Fuel Up" is designed to improve children's teamwork skills, improve their food choices, and increase their physical activity habits at school and at home. UDIM hosts hundreds of Michigan students at Ford Field in Detroit for the annual Fuel Up to Play 60 Rally.

This MSU Extension Key Partner Award recognizes UDIM's long history of supporting and promoting MSU Extension programs.



## Gordon Guyer Collaborative Programming Award

### Farm Stress Management Team

**Roger Betz, Tom Cummins, Adam Kantrovich,  
Suzanne Pish, Beth Stuever**

As U.S. and Michigan farm income has dropped sharply in the past two years, the state has seen a corresponding increase in the number of attempted and completed suicides among farm families. The MSU Extension Farm Stress Management Team, which includes representatives from several areas of the organization, was formed in response to this developing financial and mental health crisis.

The team designed a workshop for people who work with agricultural producers and farm families who want to learn about how to manage farm-related stress and how to approach and communicate with those in need. Participants learn to recognize warning signs of stress, depression, self-harm, and mental illness, and find out how to help connect stressed individuals and families with appropriate mental health resources and services.

The participants at one such workshop included 100 employees of GreenStone Farm Credit Services – including CEO Dave Armstrong. GreenStone is a strong supporter of MSU Extension and a valued member of the agricultural community, making the organization a crucial partner in the mental health discussion. (GreenStone is being honored with the Friend of Extension Award this year.)

Thirty-five MSU Extension and other agriculture industry professionals have become certified mental health first-aid providers as a result of the Farm Stress Team's efforts.

MSU Extension grows deep roots in the communities it serves, which is exemplified by the timely and tireless efforts of the Farm Stress Management Team to improve the lives of farmers and farm families. Congratulations and thank you to the whole team for your work.

## Outstanding Service to MSU Extension Award

### Julie Chapin

Julie Chapin has dedicated her 36-year career with MSU Extension to positive youth development. She began as an MSU Extension 4-H youth agent in 1981, later becoming an Extension dairy youth specialist, and then a 4-H program leader with responsibility for volunteer and staff development, risk management, and 4-H alumni relations, and oversight of the MSU Extension Child Well-being Volunteer Selection Process.

Never afraid of hard work or of being busy, in the late 1980s and through the 1990s – and in addition to her MSU Extension responsibilities – Julie served as the director of the National Center for Action in Science and Technology and the National Network for Science and Technology. Both organizations were funded by USDA grants and were dedicated to expanding opportunities for young people to explore science and technology in formal and nonformal educational settings. Julie's other national responsibilities have included serving as chair of the National 4-H Leadership Team and as a member of the National 4-H Headquarters Public Private Partnership Working Group, the National 4-H Strategic Planning Taskforce, and the National 4-H Headquarters Program Leader Working Group.

Since 2010, Julie has been the director of the MSU Extension Children and Youth Institute, the state leader of the Michigan 4-H Youth Development program, and the secretary of the Michigan 4-H Foundation Board of Trustees.

Julie has received almost \$12 million in grants to support 4-H programming across the state. She has provided leadership for youth development efforts at the state and national level, including expansion of 4-H mentoring efforts through the 4-H Mentor Michigan Initiative, youth literacy education as part of 4-H Club Read, and science education through the National Network for Science and Technology.

Julie has been recognized many times for her work, including with the Epsilon Sigma Phi National Award for Continued Excellence (2016), the MSU Distinguished Academic Staff Award (2007), the MSU Extension Meritorious Service Award (2006), and the National Distinguished Service Award from the National Association of Extension 4-H Youth Staff (1991). In 2002, she was inducted into the inaugural class of the Michigan 4-H Emerald Clover Society. Julie has served on the Governor's State Advisory Committee on Agricultural Education and as a consultant for the Michigan Statewide Systemic Initiative for Math and Science Education for the Michigan Department of Education.



## Meritorious Service Awards

### Educator

#### Katherine Ockert

Disease outbreak threatening to shut down the 4-H poultry activities at your county fair? Need help creating developmentally appropriate, hands-on, skill-building activities for 5- to 19-year-olds and the adults who work with them? With apologies to Ghostbusters, “Who you gonna call?” Why, Katie Ockert, of course. Katie’s quick thinking, adaptability, and flair for innovation are major assets in her role as a campus-based MSU Extension educator for 4-H small animal programs.

These qualities were put to the test in mid-2015, when the state veterinarian gave MSU Extension four-days’ notice of a statewide ban on poultry shows, exhibitions, and swap meets. The ban was intended to help keep a highly contagious strain of avian influenza from spreading to commercial flocks, but it came as more than 4,000 Michigan 4-H’ers were preparing to show their poultry project animals at their county fairs.

MSU Extension faced a serious challenge: Find alternative activities for 4-H poultry exhibitors that didn’t involve live birds or be forced to cancel all poultry-related 4-H activities at county fairs. Katie and a team of MSU and MSU Extension faculty, staff, and communicators set to work developing alternative poultry project activities and related educational resources.

The team soon launched a website with suggestions such as 4-H’ers showing lifelike model birds and judges using scorecards that focused on the exhibitors’ knowledge of poultry and biosecurity practices rather than their poultry handling skills. Young people could create posters, displays, and models to help educate the public about their poultry species or breed and about biosecurity and disease management practices. During the small animal livestock auction, 4-H’ers could display photos of their birds. Build-a-bird contests, skill-a-thons, and quiz bowls were other alternatives.

Katie and the team’s efforts helped change the poultry ban into a learning experience about the importance of biosecurity, adaptability, and the ability to overcome adversity.



# First Floor Westin Book Cadillac Hotel

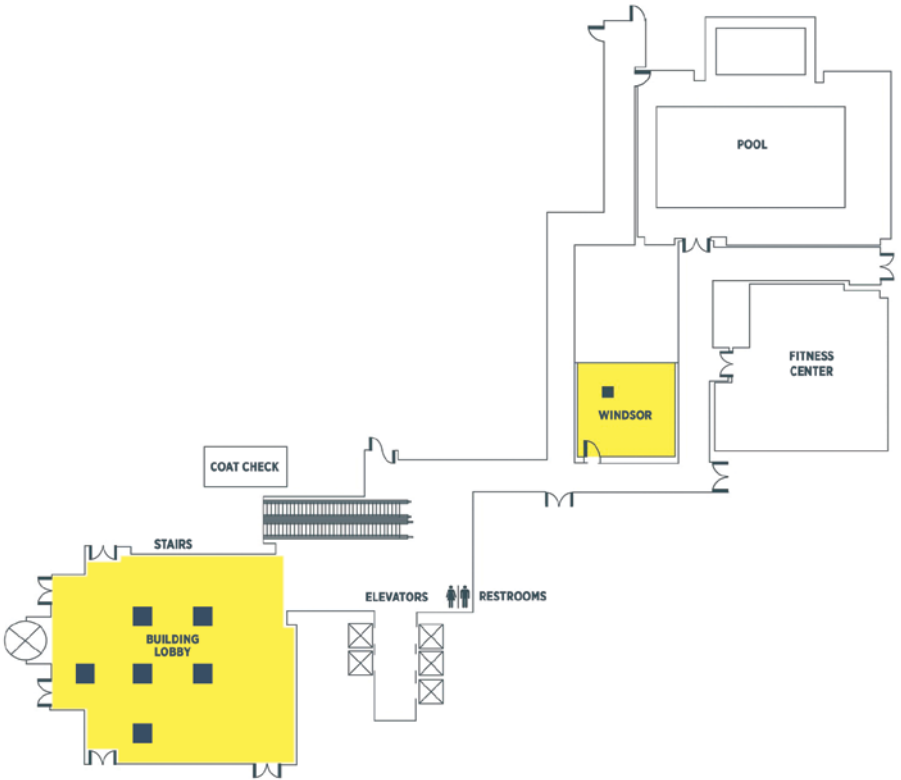



## Second Floor Westin Book Cadillac Hotel



# Third Floor Westin Book Cadillac Hotel

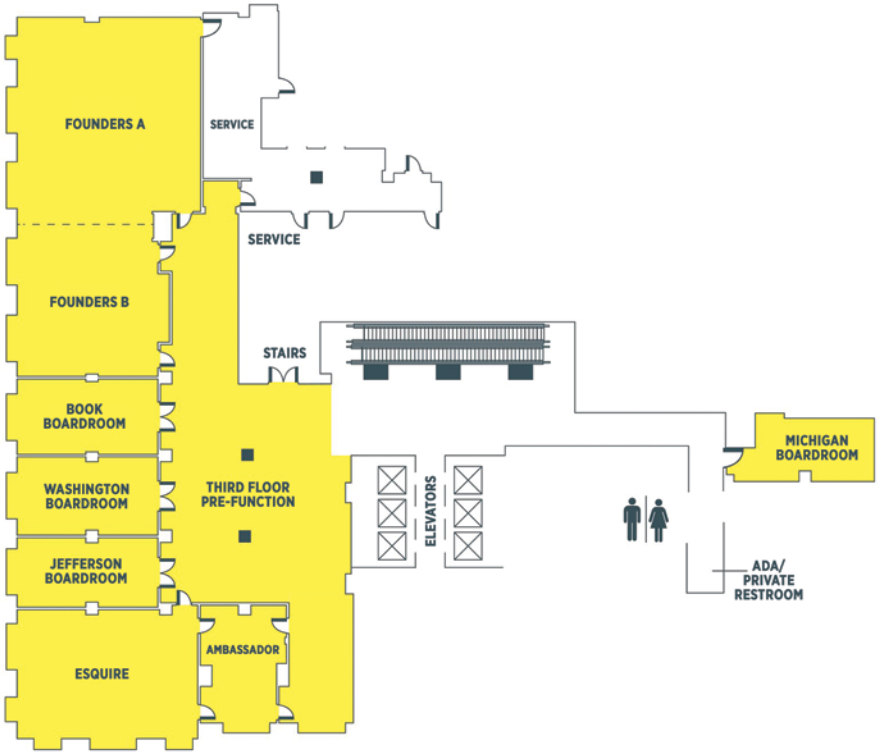



## Fourth Floor Westin Book Cadillac Hotel

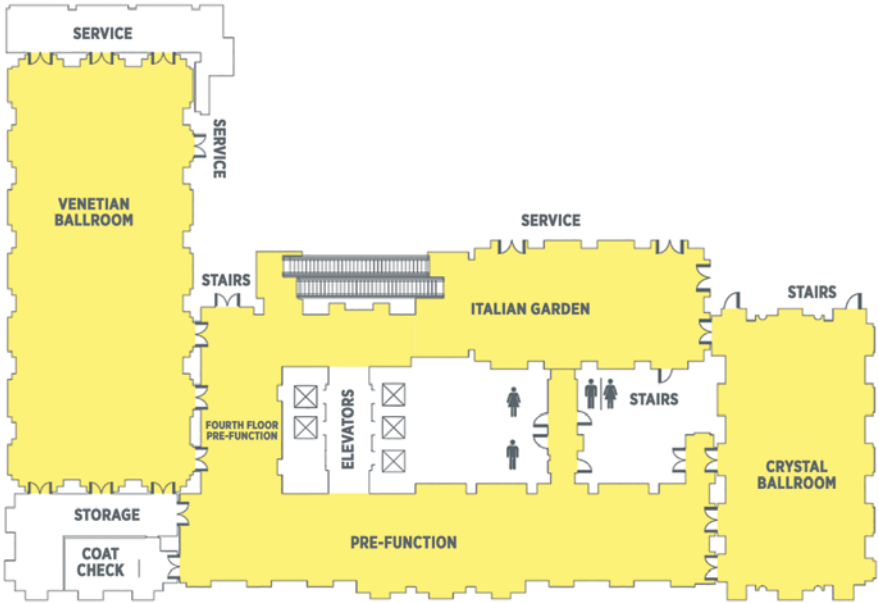

## Meritorious Service Awards (continued)

### Educator

#### Mary Wilson

When the emerald ash borer (EAB) was discovered in southeast Michigan in 2002, Mary Wilson was an MSU Extension horticulture agent in Genesee County. She soon became an EAB education coordinator, working with MSU Professor Dave Smitley to secure a state grant of more than \$400,000 to develop EAB programming, and with her counterparts in other Midwestern and Eastern states affected by the invasive beetle to write EAB educational materials and programs.

This is just one example of the versatility Mary has demonstrated throughout her 32-year MSU Extension career. Today she is a horticulture educator based in Southeast Michigan and the state coordinator of the MSU Extension Master Gardener Volunteer Program.

Mary has coordinated or been part of the MSU Extension work teams that developed the *Home Lawn and Garden Soil Test Mailer*, the Smart Gardening Initiative for consumers, and the statewide lawn and garden consumer hotline. She also led major revisions of the *Roses for the Home: Growing Roses in the Midwest* bulletin and the massive *Master Gardener Core Manual*.

Before the soil test self-mailer was developed, consumers in large counties would submit 600 to 800 soil samples a year to MSU Extension offices. The samples had to be delivered to campus for testing and then the results had to be interpreted for the consumers. Today, consumers send soil samples directly to the MSU Soil and Plant Nutrient Lab in the self-mailer, then view the test results and fertilizer recommendations online. In 2015 (the most recent data available) nearly 3,500 consumer soil tests from 82 counties were processed, a 12 percent increase over 2014.

Mary leverages her high standards and superb evaluation skills to improve every program she's involved with. We're pleased to present Mary with this award, and thank her for her outstanding work for MSU Extension and Michigan residents.

### Richard Wooten

Richard Wooten has been an asset to MSU Extension for more than 15 years as an educator, Wayne County Extension director, and employee ombudsperson. In his current position as district coordinator in District 11 (Macomb, Oakland, and Wayne counties), Richard is responsible for overseeing MSU Extension partnerships and programming for the three counties' more than 4 million residents.

Richard has played significant roles in many programs and projects, including the St. Mary's Development Project, the MSU Detroit Partnership for Food, Learning and Innovation, the issues identification process in Wayne County, negotiating the Wayne County intergovernmental agreement, negotiating annual budgets, coordinating office moves, choosing and installing wireless networks, and tackling statewide committee assignments.

MSU Extension's success depends heavily on the ability of its staff to adapt to changing community and university needs. In 2012, Richard became MSU Extension's first staff ombudsperson. His ability to inspire trust, be impartial, and maintain confidentiality served him well in the role.

Building and maintaining relationships with elected officials, county commissioners, stakeholders, and partner organizations are all in a day's work for Richard. He is a judicious problem solver and is willing to collaborate to achieve greater goals. For example, when Wayne County officials threatened to cut funding for MSU Extension from the county budget, Richard organized MSU Extension backers to testify in support of restoring the funding at county budget hearings. After hearing from 4-H'ers and others about the quality programs MSU Extension provides, county commissioners restored the county funding.

Richard wants the MSU Extension employees he supervises to know that they are appreciated, recognizing their outstanding work with awards at staff meetings. In the spirit of fair play, we're pleased to recognize Richard for his outstanding work with a Meritorious Service Award at this conference.

## **Program Instructor, Associate, Assistant & Coordinator**

### **Connie Hemingway**

Connie Hemingway's teaching experience is a significant asset in her role as a health and nutrition program instructor in Benzie County. Her dedication and commitment to Benzie County have earned her great respect from school personnel, the community, and many important partners and program stakeholders.

Connie has helped create school health teams and then partnered with them to secure grants for programs designed to equip students to live healthy lives, such as Fuel Up to Play 60, the Smarter Lunchrooms Assessment Grant, and the Building Healthy Communities: Step Up for School Wellness Program.

A colleague notes that Connie is knowledgeable and enthusiastic, writing: "It is clear that she enjoys her job tremendously." Her enthusiasm, professional attitude, superior classroom management skills, attention to detail, and willingness to reach the community in any way she can are well-known in the county. Connie consistently surpasses her annual programming goals and is tireless in pursuing increased support for health and nutrition education in Benzie County Schools.

On one occasion Connie organized a presentation to the Benzie County board of commissioners on the positive impact various grants have had in the Betsie Valley Elementary School. Students from the school sharpened their communication skills to lead the presentation and were rewarded by the commissioners with a well-deserved standing ovation.

Connie has developed and maintained extraordinary relationships with the schools she serves. She has helped make young people, school staff, and the community passionate about healthy eating and physical activity. Asa Kelly, a teacher at Betsie Valley Elementary, writes: "Simply put, Connie Hemingway has helped transform our little rural school. We would not be where we are today without Connie!"

MSU Extension employees like Connie Hemingway, who truly think outside the box and go the extra mile, empower young people to succeed. We're proud to recognize Connie's success with a Meritorious Service Award.



### Georgina Perry

Georgina Perry is an MSU Extension program instructor based in Kent County whose dedication to improving social-emotional health has resulted in community collaborations and improvements in multicultural endeavors. She has increased the number of program participants and created incredible new partnerships within the community.

Georgina is fluent in English and Spanish and has helped translate MSU Extension's *RELAX: Alternatives to Anger* series into Spanish. She has also taught 14 health and nutrition classes in Spanish. Serving as a bridge between cultures, Georgina has expanded MSU Extension's audience and made the dream of offering classes in social-emotional health in Spanish a reality.

Georgina has participated in community organizations such as the Latino Community Coalition, the West Michigan Hispanic Chamber of Commerce, the Kent County Elder Abuse Coalition, and the Multi-Agency Collaborative Council. Her work ethic and passion for what she does make her a role model for those around her. Georgina has formed more than 40 new partnerships with organizations such as homeless shelters, job training organizations, alternative education programs, and domestic violence shelters.

To sharpen her skills and make herself an even greater asset to MSU Extension, Georgina is currently pursuing a master's degree in family and consumer sciences at Western Michigan University.



**Kelli Rau**

MSU Extension's standard of excellence for 4-H program coordinators is set by people like Kelli Rau. As the program coordinator for Iosco County, Kelli has tripled the number of people who benefit from 4-H programming from fewer than 800 people to more than 1,900. She has encouraged teen members to take on leadership roles and keeps programming partners throughout the county informed of the many educational programs MSU Extension has to offer.

For example, at a summer teacher inservice training for 100 teachers from four school districts that was organized by the Iosco Regional Educational Service Agency, Kelli told the participants about all the opportunities teachers have to partner with MSU Extension through 4-H and other programs. And when a community health fair in Oscoda was on the verge of being cancelled due to a lack of leadership, Kelli worked with a colleague to revitalize the event, which brought in 40 community partner vendors and nearly 750 participants.

Kelli's dedication and organizational skills make her an outstanding 4-H program coordinator and a deserving recipient of the MSU Extension Meritorious Service Award.



### Gina Flores

Gina Flores is known as a go-to person on MSU Extension's human resources team. She is a team player, leading training events and mentoring others. Gina represents the organization in university human resources meetings and committees, then adapts what she has learned to fit MSU Extension. For example, when MSU implemented a new performance evaluation program for nonacademic employees, Gina created an MSU Extension-specific tracking system, communication plan, and realignment strategy.

Gina's extraordinary attention to detail and dedication to her work are great assets to MSU Extension. She has immensely improved MSU Extension's retirement system, which she oversees. Her tweaks and improvements to the software used to calculate retirement projections and her improved staff communication have resulted in streamlined personnel processes.

Gina is extremely dedicated to her work supporting MSU Extension employees. Her rigorous attention to detail, team mentality, sound knowledge base, and ability to think outside the box make her an outstanding asset to the MSU Extension human resources team.

**Karen Powers**

Karen Powers is a research technologist at the Northwest Michigan Horticulture Research Center, where she is responsible for monitoring the spotted wing drosophila (SWD), an invasive insect species whose control is a top priority for the Michigan cherry industry. Karen has also contributed to an expanded understanding of important fruit industry topics such as disease resistance and climate change.

The research center is a hub for research and MSU Extension programming on pest management and production of tart cherries, sweet cherries, wine grapes, and apples. Over the past dozen years, Karen has organized research trials, collected and analyzed data, and helped with outreach programs for more than 150 research projects.

Karen leads a team of technicians who deploy traps, handle weekly trappings, and contribute vital data to statewide SWD monitoring network reports. She is a creative thinker and great problem solver who designed the intricate containers to test overwintering impacts on SWD and the boxes for a cherry orchard pollination trial studying alternative pollinators.

Karen coordinates research on 100 farms. She is a hands-on worker and a favorite contact for growers – truly the face of the research center. Karen's impeccable writing and speaking skills make her a valuable resource for the research center, the fruit growing community, and MSU Extension.



## Promotion to Senior Status

The following MSU Extension staff members have earned the rank of senior status during this calendar year. We thank each of them for their significant contributions to MSU Extension.

**Erin Lizotte**  
**Bradley Neumann**  
**Brandon Schroeder**

## Milestone Years of Service

The MSU Extension staff members listed in this section have marked employment milestones during this calendar year. We thank them all for their years of dedicated service to the organization.

### 40 or More Years of Service

**Kathryn Cummings, Stephen Stewart**

### 35 or More Years of Service

**Roger Betz, Dian Liepe, Gerald Lindquist, Philip Schwallier**

### 30 Years of Service

**Rebecca Finneran, Lyndon Kelley, Martin Nagelkirk, Cathy Newkirk, Marie Ruemenapp, Christi Sovis**

### 25 Years of Service

**Tracie Abram, Rosemarie Kelly, James Lucas, William Shane, Kathryn Walicki**

### 20 Years of Service

**Debra Barrett, Jennifer Berkey, Susan Burkle, Leatta Byrd, William Cook, Catherine Drew, Phillip Durst, Cynthia Jacobi, Jean Nichols, Coral Rowley, Michael Schira, Matthew Shane, Tracy Volk, Bonnie Wichtner-Zoia, Hope Wolcott**

## **15 Years of Service**

**Patricia Adams, Laura Anderson, Amy Baker, Kelli Kolasa, Concetta Kurple, Brenda Long, Michael Monfils, Keri Morris, Bethany Prykucki, Jodi Schulz, Yesenia Velasco**

## **10 Years of Service**

**Diana Alsayed Hassan, Maria Del Real, Lori Eccles, Sara Keinath, Glenda Kilpatrick, Rebecca Krans, Jessica Nakfour, Daniel O'Keefe, Katherine Raphael, Jeannine Schweihofer, Gwyn Shelle, J. Robert Sitrine, Mark Skidmore, Tiffany Stevens, Thomas Wenzel**

## **5 Years of Service**

**Renee Carroll, Catherine Courtade, James DeDecker, Constance Diamond, Elizabeth Duran, Kathy Dykman, Shelley Frazier, Imelda Galdamez, Candace Gardiner, Sandria Graham, Sarah Graver, Derrick Harrison, Melissa Haug, Wendy Hunt, Charles Jackson, Britney James, Jeremy Jubenville, Christian Kleinjans, Ashley Kuschel, Paula Maloney, Sulaiman Mansour, Wendy Marek, Maria Millett, Debra Morgan, Mary Morris-Donaldson, Carey Northrop, Nicole Parent, Justin Selden, Michelle Smith, Karin Stevens, Debra Studebaker, Jennifer Young, Garrett Ziegler**

## MSU Extension Association Awards

MSU Extension's professional associations have presented an array of annual awards at other conferences and meetings this year, but we're pleased to recognize and congratulate these award winners again in this program.

### Community & Natural Resources Development Association Awards

#### Community Partnership Award

*Vernal Pools – Using New Technologies, Partnerships & Citizen Science to Help Understand & Protect a Critical Resource*

**Pete Badra, Julie Crick, Joshua Cohen, Tracy D'Augustino, Dan Earl, Helen Enander, Phyllis Higman, Daria Hyde, Brian Klatt, Mike Kost, Yu Man Lee, Mike Monfils, Mike Penskar, Georgia Peterson, Ed Schools, Brandon Schroeder**

Vernal pools are small ephemeral wetlands that provide essential ecosystem services and habitat during critical points in the life cycle of many invertebrates, amphibians, and reptiles. Such pools also contribute to nutrient cycling, water storage, flood control, and groundwater recharge.

The MSU Extension Vernal Pools Program is a collaborative effort of 27 public and private sector organizations and the Michigan Natural Resource Inventory (MNFI) to protect vernal pools in the state.

The team members have developed procedures and trained citizen scientists in how to monitor vernal pools. MNFI recruits and trains these volunteers through Michigan Sea Grant, land conservancies, schools, city and county governments, and other agencies.

The team members have identified and mapped more than 4,800 potential vernal pools, verified almost 600 vernal pools in the field, and created a statewide database about the pools. Thanks to their efforts, hundreds of citizen scientists (including K-12 teachers and students) have been trained, and forestry professionals throughout Michigan and the U.S. have become more aware of the importance of vernal pools.

## Innovative Program Award

### *Regulating Medical Marijuana Facilities Team*

**Ryan Coffey, Terry Gibb, Holly Madill, Brad Neumann, Kurt Schindler, Wendy Walker, Mark Wyckoff**

Michigan residents and policymakers have come to rely on MSU Extension to respond to emerging issues with high-quality, relevant programming – something the Regulating Medical Marijuana Facilities Team has proven itself to well able to handle. In September 2016, Michigan Governor Rick Snyder signed three new statutes into law that clarified and added to the state’s voter-approved Michigan Medical Marijuana Act of 2008. The new laws allow local governments to regulate medical marijuana facilities and create a seed-to-sale tracking system for marijuana production and sales.

In spring 2017, MSU Extension introduced Regulating Medical Marijuana Facilities: A Workshop for Local Government. More than 800 people – planning commissioners, professional planners, local elected officials, administrators, and municipal attorneys – participated in 14 sessions over 38 days. The workshops were held in areas of the state with the highest concentrations of medical marijuana users, and ultimately helped hundreds of local government officials serve their communities more effectively.

## Raymond D. Vlasin Award for Program Excellence

### Julie Pioch

Julie Pioch is the recipient of the 2017 Raymond D. Vlasin Award for Program Excellence for her continued outstanding programming and professionalism. Julie began her MSU Extension career in 1994, first as a natural resources program assistant, and later as an MSU Extension educator and county Extension director. Today Julie is the district coordinator for District 13 in the southwest Lower Peninsula.

Julie's natural leadership abilities and aptitude for teaching, building relationships, and facilitating change have resulted in her managing a variety of MSU Extension initiatives. She has held many leadership roles in direct service to MSU Extension, her colleagues, her local community, and the state.

Julie's work in good governance education has ranged from how to run effective meetings to conflict management to organizational strategic planning. Throughout her career, she has offered specialized consulting services that have provided townships with data they have used to develop individual master plans, capital improvement projects, and funding strategies for roads and other infrastructure projects. Julie's leadership has contributed to the success of the long-running New County Commissioner Training Workshop, which is jointly organized by the Michigan Association of Counties and MSU Extension. Julie has made outstanding contributions to MSU Extension's land use, parliamentary procedure, placemaking, and planning programs, and is regarded as a wise, encouraging, and patient mentor.



## Epsilon Sigma Phi Awards

### Administrative Leadership Award

#### Betty Blase

In 22 years with MSU Extension, Betty Blase has built a noteworthy career, moving from an entry level supervision position to county MSU Extension director, and now to district coordinator in District 7 (Allegan, Kent, and Ottawa counties) managing three county offices with more than 45 staff members.

Betty is a proponent of Lean Principles, and has taught her staff the basics of that system, and to design and maintain a self-explanatory office and local program structure that can run successfully with minimum staffing.

Betty's brings her love of flow charts and Lean Principles and Processes to the MSU Extension administrative team, along with an unwavering drive to improve the Michigan Planning and Reporting System (MiPRS). In 2013, Betty recommended appointing a group to try to improve the MiPRS system – and ultimately was asked to chair it. The committee's improvements have included changes to the software's design and functionality and the creation of tip sheets and educational sessions to improve users' ability to navigate the system and improve their reporting.

Betty strives to live into this sentence from the national Extension Professionals' Creed: "I believe in my own work and in the opportunity I have to make my life useful to humanity."

## Distinguished Service Award

### Ann Chastain

Ann Chastain retired from her position as an MSU Extension educator in natural resources, community development, and administrative programming at the end of 2016. In her 27 years with MSU Extension, Ann's professional accomplishments included the development of many relationships at the local, regional, state, and national levels. She used her group facilitation skills to help empower others to create the vision and skills they need to achieve their goals.

Ann played an important role in implementing the Cheboygan County Solid Waste Plan, which is sustained by household fees and includes recycling, composting, and hazardous waste collection. Her community development work included contributing to the design and delivery of a program funded by the Kettering Foundation that helps communities and individuals use a deliberate process to address difficult or controversial issues.

As an expert in facilitative leadership, Ann taught classes on the subject and helped write the latest editions of the manual and participant's guide that are used in MSU Extension's popular three-day facilitative leadership training program. Ann also researched and wrote about ripple effect mapping during a long-term evaluation study to document the personal and community impact of the Citizen Planner program.

## Diversity & Multiculturalism Individual Award

### Phil Tocco

Over the past eight years, Phil Tocco has collaborated with groups that help small and beginning farmers around the state comply with state and federal laws and buyers' food safety requirements. Participants in the sessions often face financial and cultural barriers to widespread adoption, so Phil works to provide culturally appropriate programming for each audience.

Beginning in 2010, Phil held hands-on food safety plan writing workshops with Amish (Plain) growers throughout the state. What started as a training for small groups of growers soon developed into training for Amish farmer cooperatives and for African American growers in Detroit-based organizations such as the Detroit Black Community Food Security Network, Greening of Detroit, and Keep Growing Detroit.

As a result of these sessions, producers' food safety practices have changed, new infrastructure purchases have incorporated food safety ideas, and market access for these growers has increased tremendously.

Phil lives by a principle best espoused by Australian Aboriginal activist and educator Lilla Watson. To paraphrase: Being there to help is a waste of time. Only by recognizing that his future is bound with theirs, can he truly be of use to them.

## Distinguished Team Award

### *Michigan Fresh*

**Marief Borgman, Stephanie Bruno, Sean Corp, Ellen Darnall, Julia Darnton, Mary Dunkel, Heather Dyer, Kristine Hahn, Eileen Haraminac, Becky Henne, Michelle Jarvie, Connie Kurple, Erin Lizotte, Joyce McGarry, Terry McLean, Laurie Messing, Jeannie Nichols, Jeannine Schwehofer, Lisa Treiber, Kendra Wills**

## Diversity & Multiculturalism Team Award

**Darren Bagley, Ron Bates, Julie Chapin, Deb Clark, Dawn Contreras, Sean Corp, Kelsey Crossman, Tom Cummins, Courtney Cuthbertson, Julia Darnton, Jeff Dwyer, Deanna East, Sam Farah, Imelda Galdamez, Deb Hamilton, Becky Henne, Dave Ivan, Shane Jackson, Kristina Jimmerson, Liz Josaitis, M. Lynette Kaiser, Sean Knurek, Nancy Latham, Terry McLean, Kendra Moyses, Heidi Mudel, Cathy Newkirk, Erin Powell, Victoria Ross, Abi Saeed, Jennifer Skornicka, Carrie Shrier, Diane Smith, Lisa Treiber, Kevin Zorowski**

## Early Career Award

**Emily Proctor**

## International Service Award

**Bonnie Wichtner-Zoia**

## Mid-Career Service Award

**Lisa Treiber**

## Retiree Service Award

**Maggie Bethel, Cheri Booth**

## Visionary Leadership Award

**Deanna East**

## Michigan Association of Extension Agents Awards

### National Achievement Award

#### James DeDecker

James DeDecker, an MSU Extension field crops educator based in Presque Isle County, is the recipient of the 2017 National Association of County Agricultural Agents (NACAA) Achievement Award for Michigan. This prestigious award recognizes excellence in professional Extension work for NACAA members with fewer than 10 years of service. An MAEA member since 2012, James has served as North Region chair, program recognition chair, professional improvement chair, and most recently, secretary. James was awarded the MAEA President's Citation in 2013 and NACAA communication awards in 2014 and 2016.

### National Distinguished Service Award

#### Thomas Guthrie

Tom Guthrie, a statewide MSU Extension educator based in Jackson County, is the recipient of the 2017 NACAA Distinguished Service Award for Michigan. This award is presented to association members with at least 10 years in Cooperative Extension, who have conducted outstanding programs and are held in high esteem by their colleagues. Tom is in his 14th year with MSU Extension, and during his tenure he has had statewide responsibilities in swine and equine programming. Tom received the MAE4-HYS Colleague Award in 2016 for his work on biosecurity and swine health management at county fairs. He continues to be an active member of MAEA after serving as president of the association and of the Michigan Council of Extension Associations in 2015.

### National Finalist Personal Column Award

#### Phillip Durst

### National Finalist Program Promotional Piece Award

#### Heidi Lindberg

### National Finalist Video Presentation Award

#### Ron Goldy

**National Search for Excellence Award****Heidi Lindberg****Regional Feature Story Award****Ben Phillips****Regional Publication Award****Brenda Reau****State Audio Recording Award****Ben Phillips****State Fact Sheet Award****Heidi Lindberg****State Individual Newsletter Award****Heidi Lindberg****State Published Photo & Caption Award****Heidi Lindberg**

## Michigan Association of Extension 4-H Youth Staff Awards

### National Achievement in Service Award

#### Julie (Thelen) Conover

Julie (Thelen) Conover joined MSU Extension in 2013 as the statewide 4-H livestock and veterinary science educator. She worked with young people, adults, and staff engaged in the 4-H beef, sheep, swine, veterinary science, and animal evaluation projects. Julie collaborated with the MSU Department of Animal Science and the MSU College of Veterinary Medicine to continue improving resources and programming for Michigan 4-H'ers enrolled in livestock projects.

Julie introduced the 4-H Animal and Veterinary Science Camp and revamped the livestock judging program. She also collaborated with the U.S. Centers for Disease Control and Prevention (CDC) on three grants intended to increase zoonotic disease education and prevention strategies for young people and members of the general public who attend animal events. During her four years with MSU Extension, Julie focused on curriculum development, creating *4-H Animal Science Anywhere* lessons and revising 4-H market beef, market hog, and other livestock resources. Julie is passionate about youth development and dedicated to “making the best better” for Michigan 4-H members. She left MSU Extension in mid-summer 2017.

## National Distinguished Service Award

### Dorothy Munn

Dorothy Munn has been a key partner in her community since becoming an MSU Extension 4-H educator in Ogemaw County in 1998. During that time, her responsibilities have fallen into three major categories: education, leadership, and supervision.

Dorothy is a gifted educator, teaching science-related topics such as animal science, engineering, and forestry to young people and adults. She is the coauthor of several lessons in the *Inquiring Minds Want to Know: Science Activities for Young Minds* series. The lessons encourage children to explore their world and learn how to ask questions and discover answers.

Dorothy used the skills she learned through the invitation-only National Extension Leadership Development Program during the three years she served as cochair of the Children and Youth Institute Science Team and her time on the CYI Stewardship Team. She was chosen to participate in the district coordinator internship program, which expanded her perspective on MSU Extension's role and impact in counties. From 2011 to 2017, Dorothy had a 50-percent assignment as a 4-H supervisor and coach. In 2017, she became a fulltime 4-H supervisor for Districts 4 and 6. She is highly regarded by the 4-H program coordinators she works with – they respect and appreciate her coaching approach. Dorothy is passionate about working with 4-H'ers and supporting 4-H staff.

## National Excellence in Animal Science Programming

### Julie (Thelen) Conover

## National Excellence in Teamwork

Elizabeth Ferry, Britney James, Leah LaVanway, Dian Liepe,  
Julie (Thelen) Conover, Colleen Wallace

## Michigan Achievement Award

### Kathy Fisher, Glenda Weiss



**Michigan Colleagues Award**

**Julie Crick, Beth Stuever**

**Michigan Communicator Award**

**Sara Lewis**

**Michigan Distinguished Service Award**

**Jackie Martin**

**Michigan Diversity Award**

**Lisa Kelly**

**Michigan Excellence in Camping Award**

**Eva Beeker**

**Michigan Partnership Award**

**U.S. Centers for Disease Control and Prevention**

**Michigan Presidential Citation**

**Debbie Morgan**

**Michigan Programming Expertise in Animal Science**

**Debbie Morgan**

**Michigan Team Effort Award**

**Barbara Duvall, Priscilla Martin, Laurie Rivetto, Sienna Suszek**

**Michigan Technology Award**

**Dee Howe, Melissa Prohaska**

## Michigan Extension Association of Family & Consumer Sciences Awards

### National & Michigan Distinguished Service Award

#### Lisa Treiber

Lisa Treiber has been with MSU Extension since 1998 and an MEAFCS member for 18 years. She has attended 12 national conferences, where she has volunteered at the registration desk, moderated sessions, and volunteered at the annual silent auction – eventually chairing it. Lisa has served as an MEAFCS regional director twice and as state president. Lisa also cochairs the Doris Wetters Foundation, which provides professional development funds to association members.

Lisa has contributed to MSU Extension and MEAFCS by providing nutrition, financial literacy, and food safety programs for Michigan residents. She has also supervised SNAP-Ed and EFNEP programs and staff in multiple counties, and collaborated with various organizations on new programming, outreach, and networking opportunities. Each year for 12 years, Lisa secured \$85,000 in funding to provide Project FRESH coupons for four area counties.

In 2000, Lisa took the lead of the new Tri-County Food Safety Task Force, which includes county sanitarians, MSU Extension educators, representatives from the Michigan Department of Agriculture and Rural Development, the U.S. Food and Drug Administration, councils on aging, and school food services directors in Bay, Midland, and Saginaw counties.

Lisa has participated in several research projects related to obesity, increasing the consumption of fruits and vegetables, and increasing physical activity levels during her MSU Extension career. She has also helped to develop educational materials and train staff in their use.

## Continued Excellence Award

### Brenda Long

Brenda Long has been an NEAFCS member since 2003, serving a term as the Southwest Region Director. She served as the state treasurer and was a state board member in 2007–2008. Brenda has been a member of the NEAFCS National Investment Committee since 2014.

Brenda's contributions have included leading train-the-trainer sessions for the U.S. Consumer Financial Protection Bureau's *Your Money, Your Goals Tool Kit* for 227 direct service providers and community volunteers in 12 Michigan cities.

Brenda copresented a webinar for the eXtension Military Families Learning Network, copresented during the AFCPE 2017 Annual Symposium, and was involved in several multistate meetings with national Extension Family Resources Management staff developing a logic model plus indicators, for a common multistate evaluation assessment.

With passage of the Affordable Care Act (ACA), health insurance literacy became an emerging issue. Brenda was awarded a nearly \$90,000 grant to bring the Extension Education and Outreach on the Marketplace Exchanges of the ACA program to Michigan. (The U.S. Department of Agriculture grant was administered by the University of Georgia.) She coordinated training, strategic plans, outreach, and delivery with 10 family-focused educators to deliver face-to-face and online sessions using the *Smart Choice: Health Insurance* curriculum. She then copresented the delivery model to MSU Extension staff, the MSU Extension and AgBioResearch State Council, and statewide and national stakeholders.

## National & Central Region Past President's New Professional Award Winner

### Kara Lynch

## First Place National & Central Region Extension Housing Outreach Award

Sarah Carter, Teresa Clark-Jones, Jean Lakin, Brenda Long,  
Wanda Roberts, Erica Tobe



## Second Place National & First Place Central Florence Hall Award

Deanna East, Cathy Newkirk, Erin Powell, Carrie Shrier,  
Lisa Treiber, Kevin Zaromski

## Third Place National & Second Place Central Region Marketing Package Award

LaShawn Brown, Jim Buxton, Sarah Carter, Terry Clark-Jones,  
Bill Hendrian, Khurram Imam, Teagen Lafere, Jean Lakin, Brenda  
Long, Beth Martinez, Scott Matteson, Jinnifer Ortquist, Pam  
Sarlitto, Erica Tobe, Beth Waitrovich, Robert Weber

## Third Place National & First Place Central Region Communications Award for Educational Publication

Tom Cummins, Suzanne Pish

## Third Place Central Region Food Safety Award

Eileen Haraminac, Jane Hart, Joyce McGarry, Laurie Messing,  
Jeannie Nichols, Lisa Treiber, Christine Venema, Beth Waitrovich

## Michigan Innovative New Programming Award

Two team awards given:

- Diane Brown, Joyce McGarry, Gretchen Voyle
- Erin Carter, Linda Cronk, Cheryl Eschbach, Maria Millett,  
Cathy Newkirk, Holly Tiret

## MEAFCS Management Award

Saneya Moore

## MSU Product Center Award

### Innovation Counselor of the Year Award

#### Wendy Wieland

The numbers have really added up for innovation counselor Wendy Wieland in the past year: She has worked with 78 clients and those clients have created 40 new jobs, made \$2.3 million in new sales, and totaled \$1.6 million in capital investments.

Wendy has been an innovation counselor since 2004, and currently serves the northwest part of the Lower Peninsula. She is particularly sought after for her skill in helping clients develop and expand value-added agricultural operations. She has worked with farms, wineries, maple syrup producers, and farmers markets. She has been a leader in the Northern Michigan Small Farm Conference, which helps build a local network of small farms, community businesses, and local government with the goal of building the local food economy.

## Conference Sponsors

We would like to thank the organizations who have so generously sponsored Fall Extension Conference 2017.

### Gold



### Silver



Office of the Vice President  
for Governmental Affairs



Health Plans for Everyone  
Individual • Group • Medicare • Medicaid



Design • Print • Copy • Mail • Large Format

**IMAGE BUILDERS  
UNLIMITED**

Powered by PROforma

### Bronze



Centra Wellness  
NETWORK



**Networks  
Northwest**  
Talent / Business / Community

### MSU Extension Institute Directors

Ron Bates  
Julie Chapin  
Dawn Contreras  
Dave Ivan

### Apple Crunch Sponsor



# My Passport to Prizes

59

Attendee name: \_\_\_\_\_

Work email address: \_\_\_\_\_

Read on to find out how to enter for a chance to win one of about 50 great prizes!

1. Write your name and email address on your passport. (No photo necessary!)
2. Listen carefully for the secret code announcement during each part of the conference. (You get one free pass.)
3. Write the secret code in the correct box on your passport.
4. Turn in your full passport after the Wednesday Wrap-Up session.
5. Join the MSU Extension All Staff Webinar from 4 to 5 p.m. on Monday, November 6, to find out whether you've won a prize!

## General Sessions on Tuesday [T] & Wednesday [W]

Enter a secret code in each of the 12 white squares. Place the name of the physical activity session or tour (marked with a  symbol in the conference agenda) that you took part in on Tuesday and Wednesday in the Physical Activity Session or Tour boxes below to complete your passport.

Institute Breakfast [T]	Welcome and Keynote Presentation [T]	Breakout Session 1 [T]
Administrative Update [T]	Lunch and Awards Presentation [T]	MSU Extension Celebration [T]
Physical Activity Session or Tour [T]	Administrative Update [W]	Lunch and Awards Presentation [W]
Director's Time and Wrap-Up [W]	Physical Activity Session or Tour [W]	Digital or Instant Camera Photo Shared or Viewed [T/W]

## Workshops on the Move 1 & Breakout Sessions 2 & 3 on Tuesday

Enter secret codes in one light green square or two dark green squares.

Belle Isle Tour	Detroit Historical Museum Tour
Detroit People Mover Tour	Eastern Market and Pingree Farms Tour
Experience Diverse Cultures & Ethnicities of Michigan Tour	Ford Field Physical Activity
Breakout Session 2	Breakout Session 3

## Workshops on the Move 2 & Breakout Sessions 4 & 5 on Wednesday

Enter secret codes in one light orange square or two dark orange squares.

Detroit District Tour	Detroit Institute of the Arts Tour
Detroit People Mover Tour	Outdoor Adventure Center Tour
D-Town Farm Tour	This square intentionally left blank.
Breakout Session 4	Breakout Session 5







## ENTERTAINMENT DISTRICT

## GREEKTOWN

## RIVERTON

## DOWNTOWN

**1-Ford Field**  
**2-Loft Detroit at the David Whitney**  
**3-Holiday Inn Express**  
**4-Westin Book Cadillac Detroit**  
**5-Hilton Garden Inn**

**Interstate Highway** **375**  
**State Highway**   
**Amtrak Station** **A**  
**Detroit People Mover** **A**  
**QLine** **A**  
**Parking** **P**

0 0.25 0.5 mile  
 0 0.25 0.5 kilometer

### People Mover Stations

<b>A</b> Times Square	<b>M</b> Millender Center
<b>B</b> Grand Circus Park	<b>N</b> Financial District
<b>C</b> Broadway	<b>O</b> Joe Louis Arena
<b>D</b> Cadillac Center	<b>P</b> Cobo Center
<b>E</b> Greektown Casino	<b>Q</b> Fort/Cass
<b>F</b> Bricktown	<b>R</b> Michigan Avenue
<b>G</b> Renaissance Center	

The People Mover's 13 stations include direct access to Cobo Center, Joe Louis Arena and Greektown Casino. Trains arrive every four minutes.

### QLine Stations

<b>A</b> Grand	<b>G</b> Martin Luther King Jr.
<b>B</b> Amtrak	<b>H</b> Sibley
<b>C</b> Amsterdam	<b>I</b> Foxtown
<b>D</b> Ferry	<b>J</b> Grand Circus
<b>E</b> Warren	<b>K</b> Campus Martius
<b>F</b> Canfield	<b>L</b> Congress

Opening Spring 2017

Detroit International RiverWalk

DETROIT RIVER

Detroit International RiverWalk





## MSU Extension Celebration Sponsor

Thank you to the United Dairy Industry of Michigan for sponsoring the MSU Extension Celebration at Ford Field.



Photo courtesy of Communications and Brand Strategy.

**MICHIGAN STATE**  
**UNIVERSITY**

**Extension**

MSU is an affirmative-action, equal-opportunity employer, committed to achieving excellence through a diverse workforce and inclusive culture that encourages all people to reach their full potential. Michigan State University Extension programs and materials are open to all without regard to race, color, national origin, gender, gender identity, religion, age, height, weight, disability, political beliefs, sexual orientation, marital status, family status or veteran status. Issued in furtherance of MSU Extension work, acts of May 8 and June 30, 1914, in cooperation with the U.S. Department of Agriculture. Jeffrey W. Dwyer, Director, MSU Extension, East Lansing, MI 48824. This information is for educational purposes only. Reference to commercial products or trade names does not imply endorsement by MSU Extension or bias against those not mentioned. The 4-H Name and Emblem have special protections from Congress, protected by code 18 USC 707. Published online and printed on recycled paper. 650-10:2017-ASAP-RM/AB